

Pitch:2.00X2.00mm(0.079X0.079")  
 Pin Header Dual Rows With Post S.M.T Type

**MXCONN**  
 MMFC2XX Series

2.00 Male S.M.T Type

**Specifications**

- Current Rating: 2.0 Ampere
- Insulation Resistance: 1000MΩ Min
- Dielectric Withstanding: 500V AC
- Contact Resistance: 20mΩ Max
- Operating Temperature: -40°C to +105°C

**Materials**

- Contact Material: Brass
- Insulation Material: Polyester,UL 94V-0  
 NYLON 6T

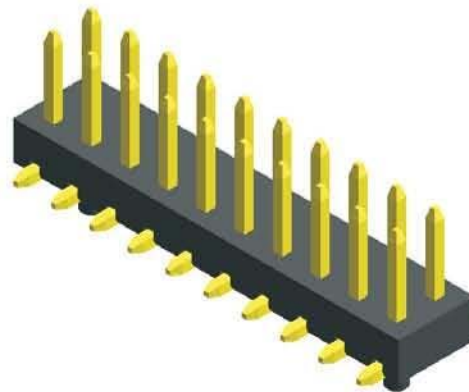

Mating with



MFFA2XX

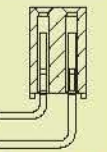

MFFB207

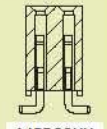

MFFC2XX

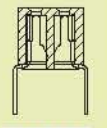

MFFD201

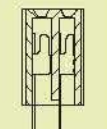

MFFA203

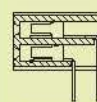
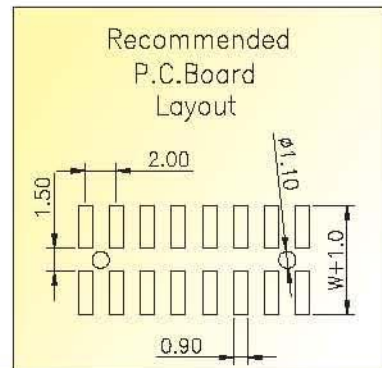
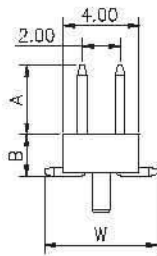
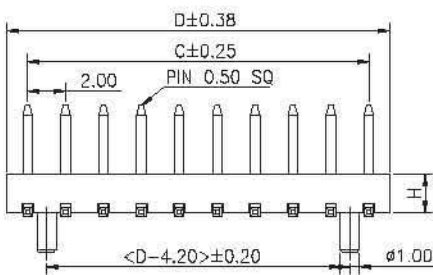
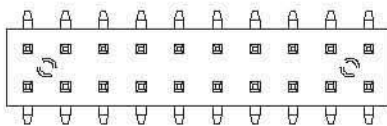

MFFB203

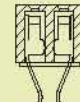

MFFE201

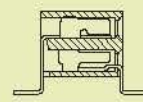

MFFC204

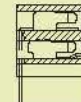

MFFB204

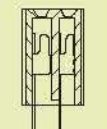

MFFA203

No. of Pins/Row	Dimension Information		No. of Pins/Row	Dimension Information		No. of Pins/Row	Dimension Information		No. of Pins/Row	Dimension Information	
	C	D		C	D		C	D		C	D
03	4.00	6.20	13	24.00	26.20	23	44.00	46.20	33	64.00	66.20
04	6.00	8.20	14	26.00	28.20	24	46.00	48.20	34	66.00	68.20
05	8.00	10.20	15	28.00	30.20	25	48.00	50.20	35	68.00	70.20
06	10.00	12.20	16	30.00	32.20	26	50.00	52.20	36	70.00	72.20
07	12.00	14.20	17	32.00	34.20	27	52.00	54.20	37	72.00	74.20
08	14.00	16.20	18	34.00	36.20	28	54.00	56.20	38	74.00	76.20
09	16.00	18.20	19	36.00	38.20	29	56.00	58.20	39	76.00	78.20
10	18.00	20.20	20	38.00	40.20	30	58.00	60.20	40	78.00	80.20
11	20.00	22.20	21	40.00	42.20	31	60.00	62.20			
12	22.00	24.20	22	42.00	44.20	32	62.00	64.20			

**Ordering Information**

MMFC2 XX	- XX	XX	X	XXX
HEIGHT OPTION (H)	No. of Pins per Row	Standard Plating	A :W / O POST	Pin Length ( A / B / W )
17 :H=2.00	03~40	02 :Gold Flash	B :WITH POST	007 :A=3.50,B=2.20,W=6.50
06 :H=1.50		Selective Plating	MMFC217 ...B	015 :A=2.00,B=2.20,W=6.50
		01 :Tin	MMFC206 ...A	Selective Length
		05 :Gold Flash / Tin		Custom Length Available

\* Standard Packaging: Tube